

HINGED COVER TYPE 3R ENCLOSURES

Application

Designed to house electrical controls, instruments and components in an outdoor environment. Protects against rain, sleet and snow. For installation information, consult our Installation Manual at www.saginawcontrol.com.

Construction

- 0.048", 0.060" & 0.075" galvanized steel.
- Concealed hinges.
- Spot weld construction.
- Rain cap.
- Mounting holes in back of enclosure.
- Provisions for sub-panel.
- Black quarter turn latches.
- Doors open 180 degrees.
- Black quarter turn latch with padlocking provisions.
- Pour in place oil and water resistant gasket.
- Ground studs on door and body.
- 3/8-16 grounding kit.
- Sub-panel mounting hardware included.

Options

Optional mounting straps or mounting foot kits available.

Finish

ANSI-61 gray powder coated inside and out. Optional sub-panels powder coated white.

IS7 Industry Standards

NEMA Type 3R
UL Listed Type 3R
CSA Type 3R
IEC 60529 IP32



118

Enclosure Product Code N3

Sub-Panel (P3)

Catalog No.	Height (A)	Width (B)	Depth (C)	Industry Standard	Catalog No.	Panel Height (D)	Panel Width (E)
SCE-12R1206LP	12.00	12.00	6.00	IS7	SCE-12DLP12	9.00	9.00
SCE-12R1208LP	12.00	12.00	8.00	IS7	SCE-12DLP12	9.00	9.00
SCE-16R1206LP	16.00	12.00	6.00	IS7	SCE-16P12	13.00	9.00
SCE-16R1208LP	16.00	12.00	8.00	IS7	SCE-16P12	13.00	9.00
SCE-20R1606LP	20.00	16.00	6.00	IS7	SCE-20P16	17.00	13.00
SCE-20R1608LP	20.00	16.00	8.00	IS7	SCE-20P16	17.00	13.00
SCE-24R2006LP	24.00	20.00	6.00	IS7	SCE-24P20	21.00	17.00
SCE-24R2008LP	24.00	20.00	8.00	IS7	SCE-24P20	21.00	17.00
SCE-24R2012LP	24.00	20.00	12.00	IS7	SCE-24P20	21.00	17.00
SCE-24R2016LP	24.00	20.00	16.00	IS7	SCE-24P20	21.00	17.00
SCE-24R2408LP	24.00	24.00	8.00	IS7	SCE-24P24	21.00	21.00
SCE-24R2412LP	24.00	24.00	12.00	IS7	SCE-24P24	21.00	21.00
SCE-24R2416LP	24.00	24.00	16.00	IS7	SCE-24P24	21.00	21.00
SCE-30R2408LP	30.00	24.00	8.00	IS7	SCE-30P24	27.00	21.00
SCE-30R2412LP	30.00	24.00	12.00	IS7	SCE-30P24	27.00	21.00
SCE-30R2416LP	30.00	24.00	16.00	IS7	SCE-30P24	27.00	21.00
SCE-36R2408LP	36.00	24.00	8.00	IS7	SCE-36P24	33.00	21.00
SCE-36R2412LP	36.00	24.00	12.00	IS7	SCE-36P24	33.00	21.00
SCE-36R2416LP	36.00	24.00	16.00	IS7	SCE-36P24	33.00	21.00
SCE-36R3008LP	36.00	30.00	8.00	IS7	SCE-36P30	33.00	27.00
SCE-36R3012LP	36.00	30.00	12.00	IS7	SCE-36P30	33.00	27.00
SCE-36R3016LP	36.00	30.00	16.00	IS7	SCE-36P30	33.00	27.00
SCE-42R3012LP	42.00	30.00	12.00	IS7	SCE-42P30	39.00	27.00
SCE-42R3016LP	42.00	30.00	16.00	IS7	SCE-42P30	39.00	27.00

HINGED COVER TYPE 3R ENCLOSURES

TECHNICAL DATA

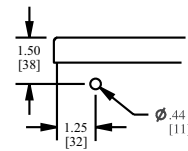
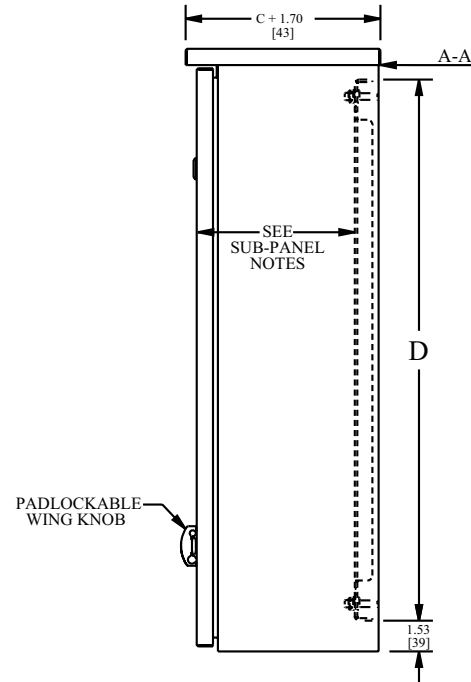
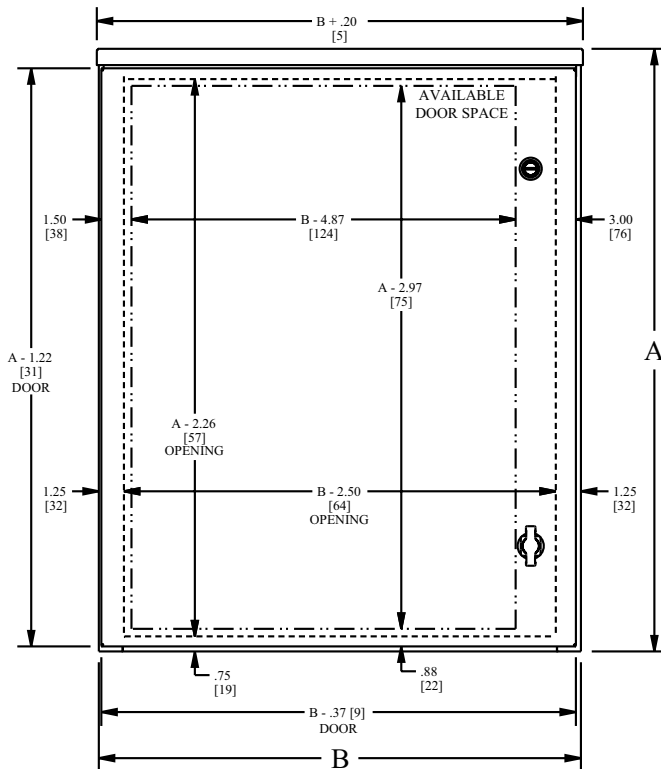

MOUNTING HOLES
TYPICAL 4 PLACES
DETAIL A-A

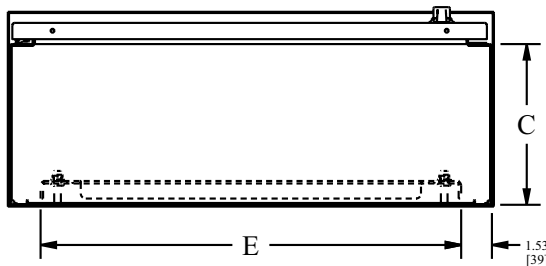

LATCH NOTES:
Enclosures < 24.00 [610] high require only one latch centered on door.

Enclosures \geq 24.00 [610] AND < 40.00 [1016] high require two latches on door

Enclosures \geq 40.00 [1016] high require three latches.

SUB-PANEL NOTES:
Dimensions are from the inside of the door
C + 0.32 [8] for flat sub-panels
C + 0.18 [5] for bent sub-panels